

# Transportation Services Update #3

**Committee of the Whole,  
September 26, 2016**

Rachel Prudhomme, M.Sc., P.Eng.

Director, Engineering Services

Prepared by:

Transportation Services Team



## **Purpose:**

To update Council on some of E.S.'s innovative transportation initiatives in 2016:

- a) Water Street Refuge Island
- b) Visibility Improvement at Intersections Campaign
- c) In-road Bollards Pilot Project
- d) Boulevard Lawn Sign Program
- e) Solar Pole-Mount Radar Boards Pilot Project
- f) Downtown Parking Expansion – Fairy Lake

# Water Street Refuge Island



September 22, 2016

**The Water Street Refuge Island is proceeding ahead of schedule and is expected to be completed by the end of September.**

## Visibility Improvement at Intersections Campaign



### Purpose:

To provide better visual contrast for motorists to see pedestrians crossing at intersections.



**Srigley and Alexander intersection ladder markings.**

**The ladder markings are on all three or four legs of the intersection.**



## **Visibility Improvement at Intersections Campaign**



**Locations were chosen based on a combination of traffic and pedestrian volumes.**

**Intersections also need to have proper boulevard treatments (e.g.: sidewalks, proper sidewalk apron and curb depressions).**

**The program runs for 4 years starting in 2016:**

- The first 3 years will see one intersection per Ward being added annually;**
- The 4<sup>th</sup> year will allow for any additional locations identified to complete the program.**



## Visibility Improvement at Intersections Campaign

**The list below shows the current two-year plan. Ladder markings at all intersections for 2016 have been completed. The proposed locations for 2017 are subject to field verification.**

### **2016:**

Stonehaven/Kingsmere  
Srigley/Alexander  
Huron Height/Wayne  
Stiver/Bristol  
Queen/Main  
Doubletree/Jordanray  
Woodspring/Aspenwood

### **2017:**

Kingsmere/Ivsbridge  
Srigley/Carlson  
Waratah/Elgin  
Main/London  
Eagle/Sandford  
Savage/Sandford  
Bonshaw/Coach Whip

# In-Road Bollards Pilot Project



**INNOVATIVE Newmarket project**

**Effect similar to speed humps**

**Three locations:**

- 1. Ivsbridge (east of Kingsmere)**
- 2. Savage (west of Sandford)**
- 3. Savage (south of Armitage PS)**

**The three locations chosen represent different road characteristics.**



## **In-Road Bollards Pilot Project**



**The purpose of this pilot program is to:**

- 1. Test an alternative method of slowing vehicles on Town roads (other than speed humps)**
- 2. Test bollard design for potential use with the East-West Bicycle Route and other applications**



# Boulevard Lawn Signs



Newmarket

**The Town of Newmarket is a leader/innovator in this area. Many other municipalities are following our lead and asking for advice.**

**Councillors and residents can request signs, and Engineering Services will install and monitor them and will retrieve them after a month or so to avoid sign fatigue. Only 100 were produced in 2016, so sign placement is generally restricted to collectors and higher volume local roads.**

**Boulevard Lawns Signs are also placed in tandem with the speed management trailers and pole-mount radar boards; they are left in place for a few weeks after the speed monitoring devices have been removed.**



## Solar Pole-Mount Radar Boards – Pilot Project



A pilot project involving solar powered pole-mount radar boards will determine the performance and effectiveness of these new devices. Information Report ES 2016-41 provides more details.



**Solar Pole-Mount on  
Srigley Street**



# Solar Pole-mount Radar Boards – Pilot Project

## Overall Summary

Total Days of Data: 1

Speed Limit: 40

Average Speed: 32.10

50th Percentile Speed: 33.54

85th Percentile Speed: 42.29

Pace Speed Range: 31 to 41

Minimum Speed: 5

Maximum Speed: 80

Display Status: Displayed Vehicle Speeds

Average Volume per Day: 3102.0

Total Volume: 3102

This is a summary of the information collected.

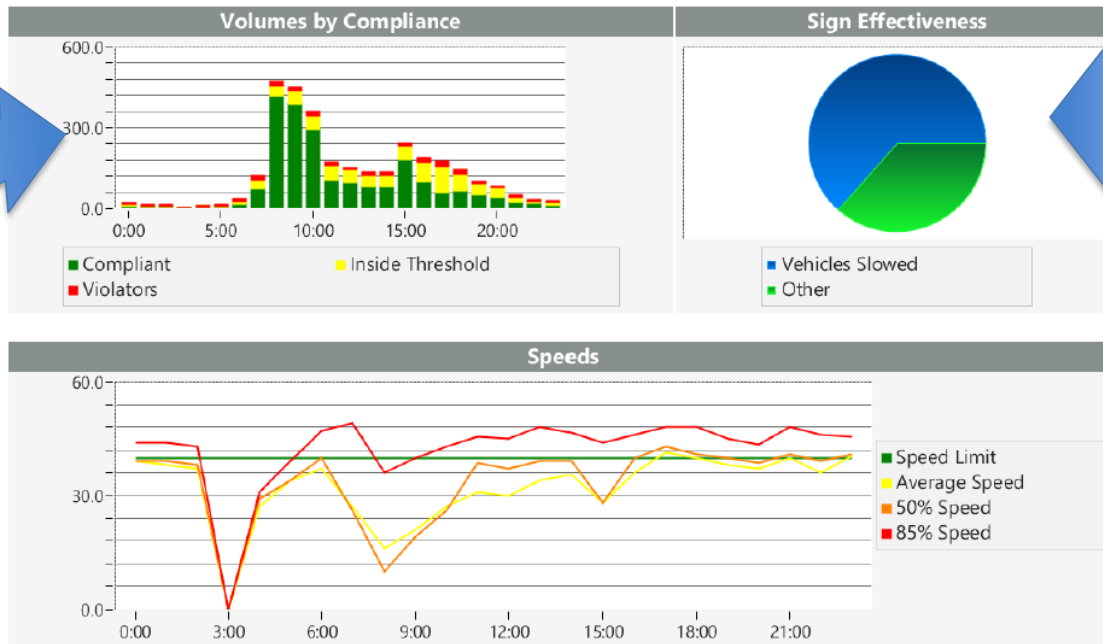

“Sign Effectiveness” shows the percentage of cars that slowed down as a result of the presence of the sign. The longer the sign is in place, the lower the percentage becomes. The test here is to see if there is a particularly duration that is optimum.

Speed violators (i.e. those above the 85<sup>th</sup> percentile) in the Volume by Compliance chart are shown in **RED**. Note that almost 100% of motorists driving between 1am and 5 am were speed violators.

## Downtown Parking Expansion – Fairy Lake

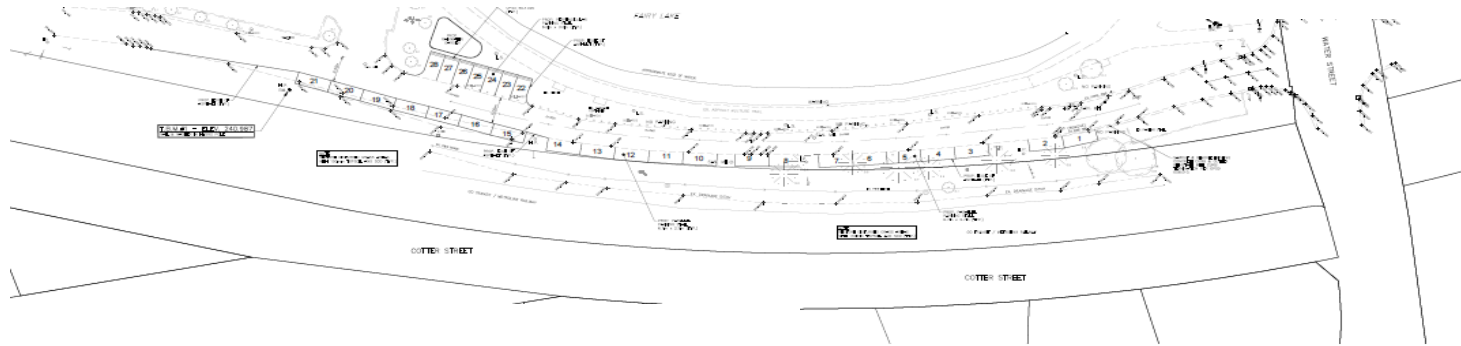

- Originally 34 new spaces (all perpendicular)
- New design is for 28 spaces (21 parallel & 7 perpendicular)
- Cost to install will be approximately \$3,900 per space (total of \$110K)
- Start & completion dates are subject to Hometown Hockey event of October 15; dates also dependent on acquiring all permits and on weather.



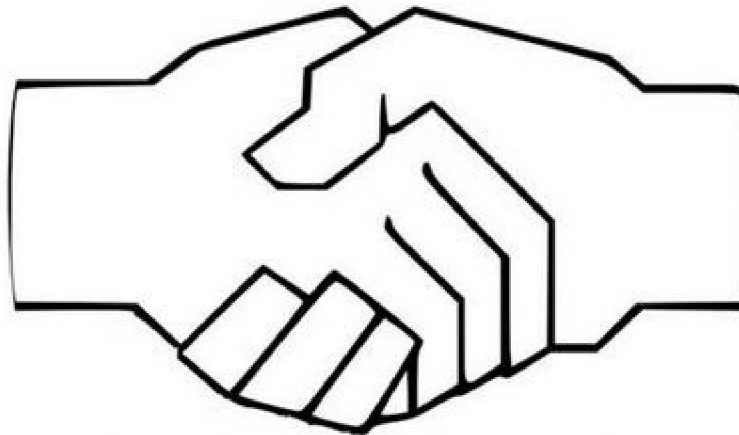

**THANK YOU**