



**CORPORATION OF THE TOWN OF NEWMARKET**

**BY-LAW NUMBER 2015-37**

A BY-LAW TO EXEMPT CERTAIN LANDS FROM THE PART LOT CONTROL PROVISIONS OF THE PLANNING ACT.

(Mosaik Homes, Lots 29 through 36 Inclusive, Lots 67 through 74 Inclusive and Lots 85 through 89 Inclusive, Plan 65M-4436)

WHEREAS it is deemed advisable to exempt certain lands from the provisions of Section 50(5) of the Planning Act, R.S.O. 1990, c.P.13;

AND WHEREAS the land use to be accommodated by the exemption, the parcel to be created, and any remaining parcel, are in conformity with the governing Official Plan and are permitted and in conformity with the Zoning By-law in effect for the area in question;

AND WHEREAS Plan 65M-4436 was registered on December 14, 2014 and the construction of the units have now advanced to a point where it is appropriate to enact the required by-law;

THEREFORE BE IT ENACTED by the Municipal Council of the Corporation of the Town of Newmarket as follows:

1. The provisions of Section 50(5) of the Planning Act, R.S.O. 1990, c.P. 13 do not apply to the lands described as Lots 29 through 36 Inclusive, Lots 67 through 74 Inclusive and Lots 85 through 89 Inclusive, Registered Plan 65M-4436 and further described as Parts 1 through 16 inclusive, Plan 65R-35861 and Lots 1 through 27 inclusive, Plan 65R-35862 Town of Newmarket, Regional Municipality of York.
2. THAT the Municipal Solicitor or her designate be authorized and directed to electronically sign and register this By-law on title;
3. AND THAT this By-law will lapse after a period of 2 years from the date of enactment.

ENACTED THIS 14<sup>TH</sup> DAY OF SEPTEMBER, 2015.

\_\_\_\_\_  
Tony Van Bynen, Mayor

\_\_\_\_\_  
Andrew Brouwer, Town Clerk

# LOCATION MAP FOR BY-LAW 2015-37

Lots 29 through 36 inclusive, Lots 67 through 74 inclusive  
and Lots 85 through 89 inclusive on Plan 65M-4436

Town of Newmarket

Regional Municipality of York

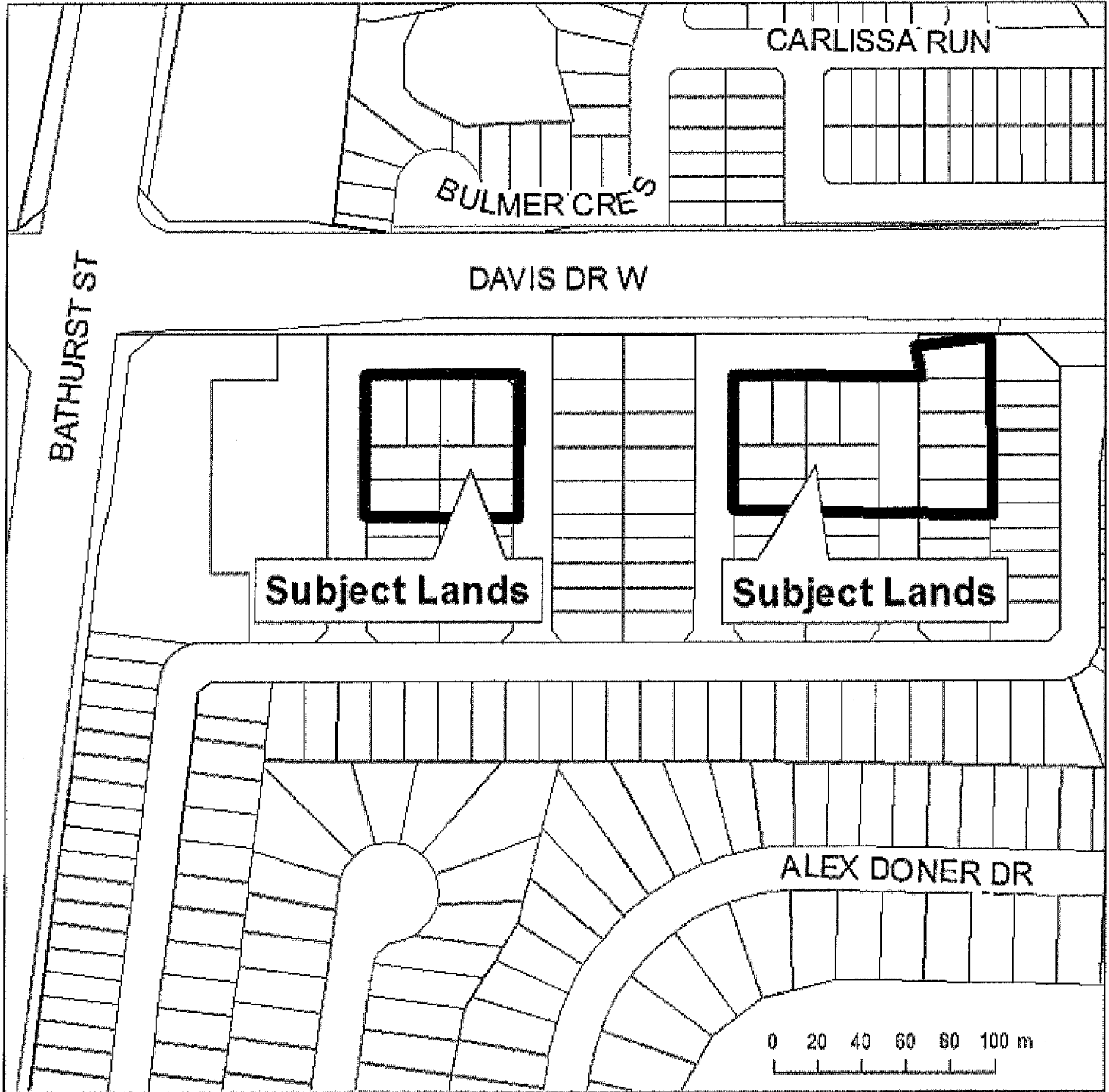

FOR INFORMATION PURPOSES ONLY



Designed & Produced by Informatica Technology - GIS Printing, September, 2015. Land Parcel Boundaries - © Teradata and its suppliers. All rights reserved. NOT A PLAN OR SURVEY. 2015. Espring - Town of Newmarket 2015. 0-52-0-0-0-0. This mapping is based on the PQUARIS parcel data provided, compiled using Land Registry System records and recent surveys and control points where available. This mapping is a representation of the work a surface and provides estimates of area and distance. This map has been created for illustrative purposes only. It is not a substitute for a legal survey.