

SIDEWALK RAMP - SEPARATE CROSSWALKS

SIDEWALK RAMP - INTERSECTING CROSSWALKS

DRAFT

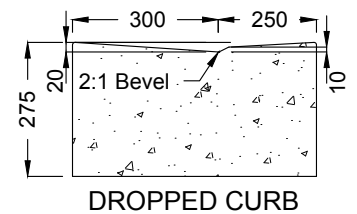
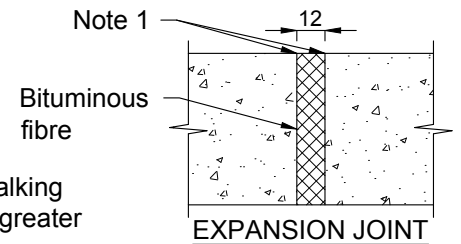
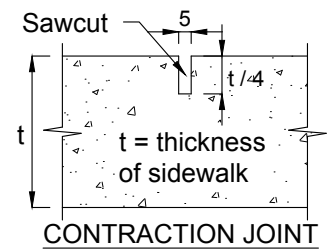
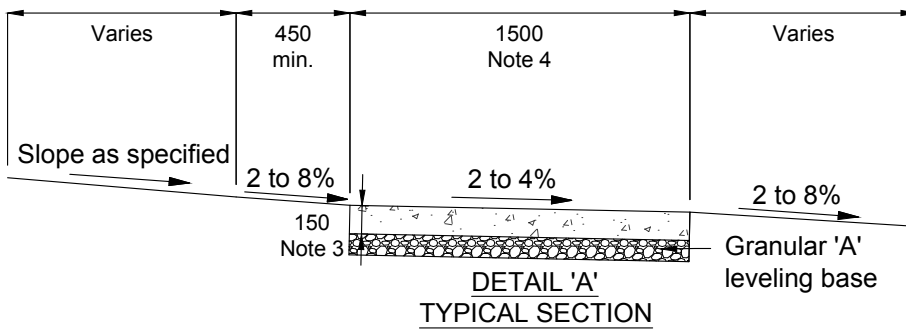

NOTES:

1. Expansion joints shall be finished in a manner to maintain a uniform and flush walking surface, and shall be placed every 3rd sidewalk bay or 4.5m. Where spacing is greater than 4.5m but less than 9.0m, an expansion joint shall be placed at the midpoint.
2. Contraction joints shall be sawcut every 1.5m.
3. Sidewalk thickness at ICI driveways shall be 200mm. Sidewalk ramps adjacent to curb shall be 200mm thick.
4. Width of sidewalk shall be 1.8m where feasible, 2.4m at schools, bus stops and other high volume pedestrian areas.
5. Concrete strength shall be minimum 32MPa at 28 days with 7% \pm 1.5 air entrainment.
6. Concrete class shall be C-2
 - a) All dimensions are in millimeters unless otherwise shown.
 - b) This NMSD shall be read in conjunction with OPSD 310.030, 310.031, 310.032, 310.033 and OPSS 351.

TOWN OF NEWMARKET MUNICIPAL STANDARD DRAWING	FEB/19	REV	3
CONCRETE SIDEWALK WITH BOULEVARD AND SIDEWALK RAMPS			
	NMSD - 208.00		